

# 6 DEALER MANUAL FOR H310 (RM G050.250.D)

---



## CONTENT

---

<b>6.1 Introduction</b> .....	<b>2</b>	<b>6.3 Drive Unit Installation</b> .....	<b>4</b>
<b>6.2 Specifications</b> .....	<b>3</b>	6.3.1 List of Tools to be used .....	4
6.2.1 Outline and geometric size .....	3	6.3.2 Motor Installation .....	4
6.2.2 Surface .....	3	<b>6.4 Maintenance</b> .....	<b>5</b>
6.2.3 Storage Information .....	3		

# 6.1 INTRODUCTION

---

- **Appearance**



- **Product Model**

RM G050.250.D

- **Scope**



Applies only to electrically powered pedelecs developed or licensed by Bafang. It is suitable for city and trekking bikes, which have been developed for road use. The engine is not suitable for sport competitions.

- **Identification**

The following graphic, is the identification numbers of the product, which are shown on the housing:

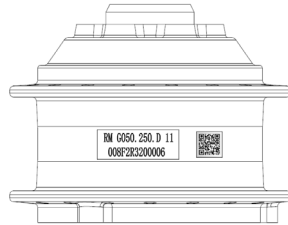

**Note:** Content in the label is important information about this product. Please do not remove the information from the motor.

## 6.2 SPECIFICATIONS

Motor model: RM G050.250.D

Rated power	250W
Rated voltage	36V
Waterproof	IP65
Certification	CE-EMC
Outdoor Temperatures	-20 °C~45 °C

### 6.2.1 Outline and geometric size

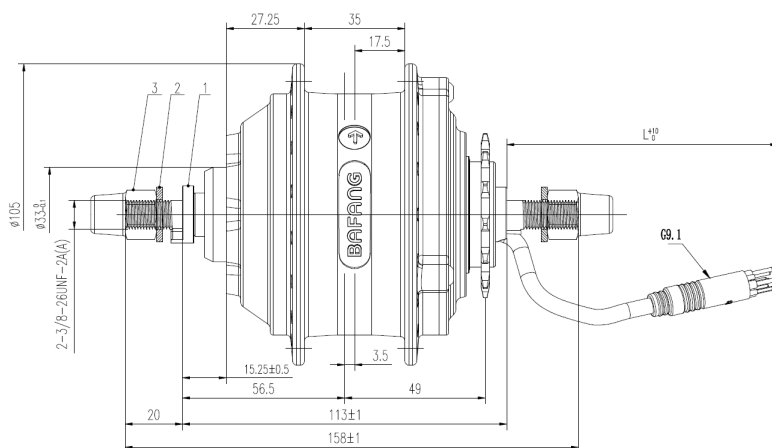

OLD: 113mm

Shaft length: 158mm

Motor cable length: L=250mm (optional)

### 6.2.2 Surface



Shockproof black or silver coating

### 6.2.3 Storage Information

The pedelec should be stored in a ventilated dry room. Avoid storing the pedelec near strong magnetic objects.

# 6.3 DRIVE UNIT INSTALLATION

## 6.3.1 List of Tools to be used

Use of the Tools	Tools
To tighten/loosen the BC3/8 cap nut.	 Open-end wrench
To tighten/loosen the M5*8 hex screws onto the disc brake.	 Internal hex wrench

## 6.3.2 Motor Installation

1. Mount the stop pin onto the shaft of motor's non-wire end.

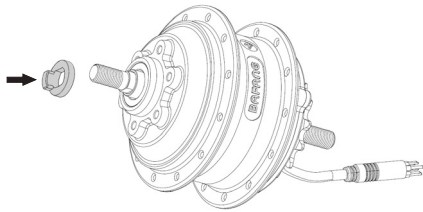

2. Tighten the disc brake onto the motor with six M5\*8 screws and place the motor onto the frame.

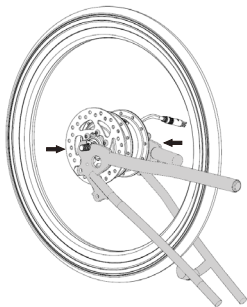

3. Mount the washers onto the shaft from both sides.

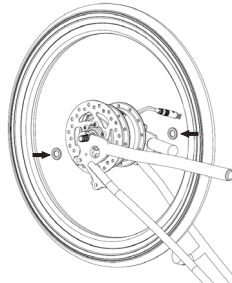

4. Fasten the BC3/8 cap nuts clockwise onto the shaft ends with an open-end wrench. Torque requirement: 30-36 N.m.

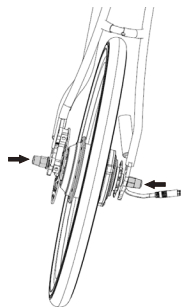

## 6.4 MAINTENANCE

---

- Maintenance must be carried out by authorized personnel with the correct equipment.
- Do not disassemble the motor.
- Do not use thinners or other solvents to clean the components. Such substances can damage the surfaces.
- Avoid water submerging, to keep the components protected.
- Avoid using high-pressure cleaning jets.
- For prolonged storage, turn off the battery and avoid storing near heat sources.